

## COMPASS MANUAL

### ARC JET THUMB COMPASSES

## HOW TO NAVIGATE

### ORIENTING THE MAP TO NORTH

The easiest way to use a map and compass together is to orient the map towards north. Simply align the map meridians with the compass needle so that "up" on the map is pointing north. Now everything on the map is in the same direction as on the ground. When travelling along your route, remember to keep the map oriented at all times. By doing this it will be very easy to follow your route since turning right on the map also means turning right on the ground! Properly orienting the map is quick, easy and the best way to avoid unnecessary mistakes.

## EASY AS 1-2-3

### THE SILVA 1-2-3 SYSTEM

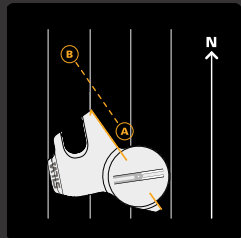

### FIXED HOUSING

#### 1-2-3

Place your compass on the map and use the **baseline** to make a straight line between your current position and your destination.

Make sure the **sighting line** points towards your destination.

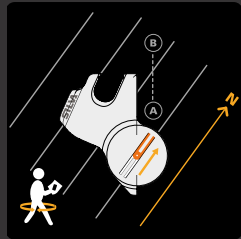

#### 1-2-3

Turn yourself and the compass until the **compass needle** is parallel with the **map meridians** and the orange part points north on the map.

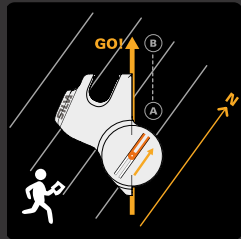

#### 1-2-3

Now the **sighting line** will point towards your destination. Take a landmark and start moving. Enjoy!

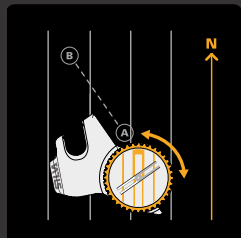

### ROTATABLE HOUSING

In **step 2** - turn the **compass housing** until the **orienting lines** are parallel with the **map meridians**.

In **step 3** - Lift your compass from the map and turn yourself until the **needle** is aligned with the **orienting lines**. Now the **sighting line** will point towards your destination.



### SPECTRA HOUSING

After **step 2** - note the Spectra reference number that the **needle** is pointing at. In **step 3** - the **sighting line** will point towards your destination as long as the **needle** points at the number from step 2.

## BASIC COMPASS FEATURES

### ARC JET THUMB COMPASSES

The high-performance Arc Jet thumb compasses are perfect for the orienteer, adventure race athlete, and you who needs a fast, stable needle and clear map visibility for quick navigation while running.

The SILVA thumb compasses come as either **Left** or **Right** version. The left version is placed on your left hand, which is the most commonly used. Choose compass based on your personal preferences.

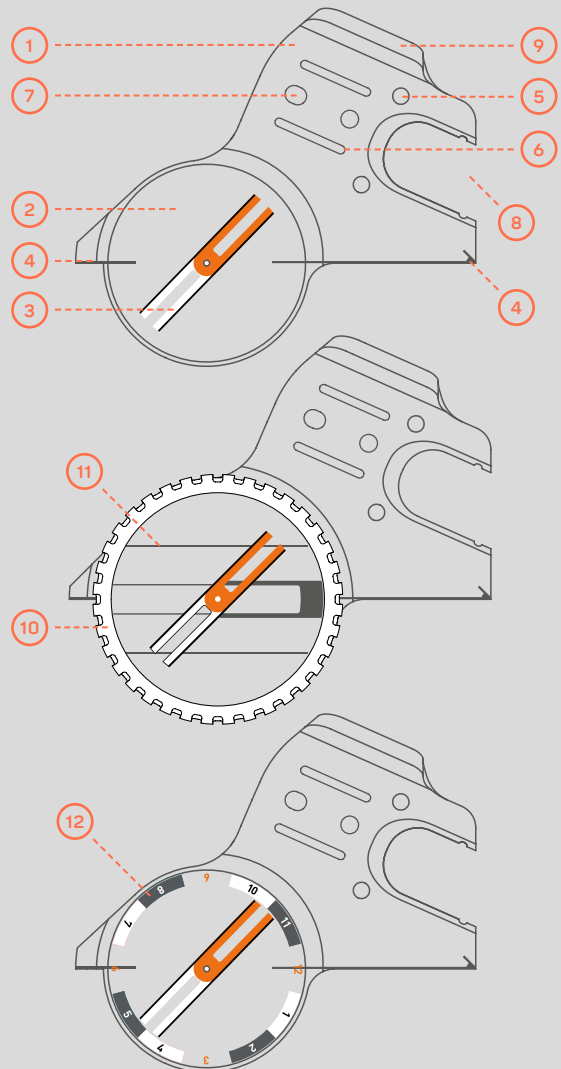

- |   |   |    |                           |
|---|---|----|---------------------------|
| 1 | BASEPLATE                                 | 7  | MAGNIFIER ATTACHMENT      |
| 2 | LIQUID FILLED CAPSULE                     | 8  | CUT-OUT FOR THUMB         |
| 3 | COMPASS NEEDLE                            | 9  | ARC WING                  |
| 4 | SIGHTING LINE / DIRECTION OF TRAVEL ARROW | 10 | ROTATABLE COMPASS HOUSING |
| 5 | RUBBER FRICTION FEET                      | 11 | ORIENTING LINES           |
| 6 | THUMB BAND ATTACHMENT                     | 12 | SPECTRA SPEED DIAL        |

## COMPASS MANUAL ARC JET THUMB COMPASSES

### BASIC COMPASS FEATURES

#### ARC JET THUMB COMPASSES

#### 1 BASEPLATE

The baseplate is made of highly durable material to withstand tough handling and both material and design provides lots of transparency – thus increasing map visibility. Use the edge of the baseplate to get your bearing.

#### 2 LIQUID FILLED CAPSULE

The capsule is filled with anti-static liquid (customized formula) that ensures clear reading, fast settling time, perfect dampening, stability and accuracy of the needle.

#### 3 COMPASS NEEDLE

The magnetic needle features a combination of a sapphire jewel bearing and a hardened steel pivot that minimises friction, which in turn gives rapid and accurate movements. Magnetic north direction accuracy: 1 degree. The orange end points to magnetic north!

**JET 2.0 needle:** provides world class performance in needle speed and settling time and it offers outstanding reliability and stability.



#### 4 SIGHTING LINE / DIRECTION OF TRAVEL ARROW

The sighting line shows the direction that you want to travel along or the bearing you are taking. It runs along the edge of the baseplate and continues at the centre back of the baseplate to let you visualize a line through the compass housing.

#### 5 RUBBER FRICTION FEET

Silicon rubber friction feet for precision map work. Placed at the bottom side of the baseplate near the thumb grip for extra stability.

#### 6 THUMB BAND ATTACHMENT

The thumb compass is attached to one's thumb using a small elastic band. The band is easy to adjust and makes the compass fit comfortably on your hand.

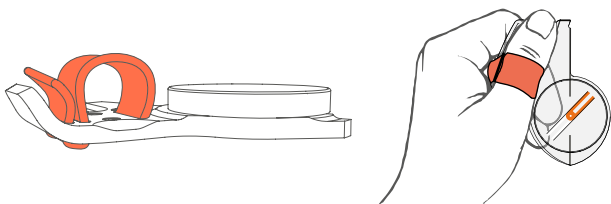

#### 7 MAGNIFIER ATTACHMENT

Holes for attaching the separately sold Arc Zoom magnifier. The Zoom is easily attached to the baseplate. Due to its functional design it becomes well integrated with the compass.

#### 8 CUT-OUT FOR THUMB

The baseplate has a cut-out to provide perfect contact between thumb and map. For those who prefer the more classic thumb grip - there is also an attachable thumb plate.

#### 9 ARC WING

The Arc wing design of the base plate gives a very good support between the thumb and the index finger.

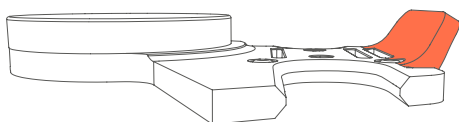

#### 10 ROTATABLE COMPASS HOUSING (BEZEL)

Use the rotatable compass housing by rotating the grip ring when navigating with the SILVA 1-2-3 system. The unique feature of a rotatable compass housing on a race thumb compass gives you the opportunity to use a thumb compass even if you are used to navigating with a traditional baseplate compass.

#### 11 ORIENTING LINES

The thumb compasses with rotatable housing have lines/markings on the capsule bottom to ensure easy settling. The lines are fixed within the compass housing, rotates along with the grip ring and are designed to be aligned with the map meridians. The lines are used to align the compass housing with the map in step 2, when navigating with the SILVA 1-2-3 system.

#### 12 SPECTRA SPEED DIAL

Originating from the Silva Spectra System and developed to simplify your orienteering. The Spectra speed dial consists of reference marks and numbers on the capsule.

You just need to memorize the number that the needle is pointing at after completing step 2 of the Silva 1-2-3 system and the sighting line will guide you in the right direction as long as the needle stays pointing at that number.

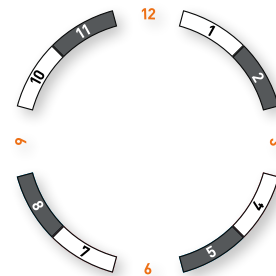

Designed like a clock, the speed dial is easy to read and memorize and enables you to move faster and more accurately while orienteering. No matter if you are an elite or leisure orienteer - the Spectra speed dial will help you stay on the right course at high speed while reducing mistakes.

You will become faster by navigating more accurately, if you think more clearly. During periods of high stress and extreme physical work we know that the brain does not get as much energy as at rest. Sometimes you think less rationally. The tougher the work, the harder it is to make the right decision and do the right thing - quickly. To think clearly, you have to keep things simple.

With the Spectra compasses you have an easier system and clearer reference points, which help you keep the right directions at competition speed.

#### ● USING SPECTRA WITH THE 1-2-3 SYSTEM:

1. Place your compass on the map and use the baseline to make a straight line between your current position and your destination. Make sure the Sighting line points towards your destination.
2. Turn yourself and the compass until the compass needle is parallel with the map meridians and the orange part points north on the map. Note the reference number that the needle is pointing at and memorize it. (for example "two o'clock").
3. The Sighting line will point towards your destination as long as the needle points at the reference number from step 2 (two o'clock). Take a landmark and start moving.

#### ● ADVANTAGES WITH THE SPECTRA SPEED DIAL:

- You don't need to hold the compass orientated on the map, in order to travel on the desired bearing.
- You can run on a compass bearing at high speed.
- Taking the step from using the traditional baseplate compass to using a thumb compass is made easier.
- You have more freedom to choose whether to run with the map and compass in the same hand or with the compass in one hand and the map in the other.
- The use of marks and numbers as reference points reduces the risk of making mistakes at extreme levels of physical and mental fatigue.
- The use of the clock design makes the teaching and learning of how to use the compass easier. It simplifies the explanation of how to use a map and compass to youths and beginners.
- The grey/white/transparent segments and orange numbers are easier to find and focus on, especially at high speed and you can correct your direction without stopping.



# COMPASS MANUAL

## ARC JET THUMB COMPASSES

### COMPASS ACCESSORIES

#### FEATURES

##### ARC JET THUMB COMPASSES

###### ATTACHABLE THUMB PLATE

The Arc Jet standard models come with an attachable thumb plate for those who prefer the more classic thumb grip. Simply slide it on/off to the baseplate with a simple click. Just try it out and see what you like best.

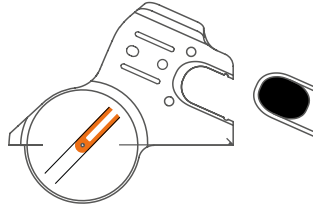

###### THUMB BANDS

The thumb compass is attached to one's thumb using a small elastic band. The band is easy to adjust and makes the compass fit comfortably on your hand. The silicone string on the inside ensures that the compass will not become loose while running. The Arc Jet series uses three different thumb bands. Firm and soft version for standard models and a smaller band for the compact Arc Jet models.

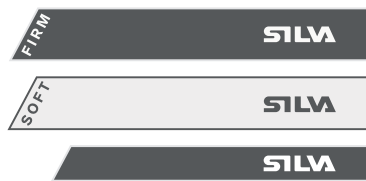
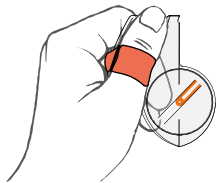

###### SCALE STICKERS

This set of stickers with printed scales is a useful tool when you need to do detailed map work, measurements on the orienteering map or preparations. The stickers are easily attached to the baseplate of your thumb compass.

The sticker set contains four different scales (2 of each): 1:15 k, 1:10 k, 1:7.5 k, 1:4 k.



###### ZOOM MAGNIFIER

For more detailed map reading, you can get the Arc Zoom magnifier as an optional accessory. The Zoom is easily attached to the baseplate of your thumb compass. Due to its functional design it becomes well integrated with the compass.

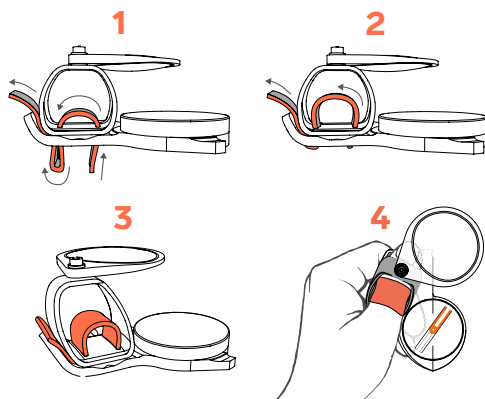

### MORE INFORMATION

#### CAN I USE MY COMPASS IN ANY PART OF THE WORLD?

Most SILVA compasses are balanced for one of three magnetic zones. Using your compass in the "wrong" zone will cause the needle to tilt and may result in it getting stuck against the roof/floor of the capsule and showing an incorrect north.

Silvas compasses are balanced in three different zones: MN (Magnetic North), ME (Magnetic Equator), MS (Magnetic South). Make sure to buy a compass for the magnetic zone you will navigate in.



#### TAKE CARE OF YOUR COMPASS

A SILVA compass will, if treated carefully, be a navigation partner for many, many years. Always check that your compass is functioning properly before heading out.

- Never expose your compass to extreme temperatures (above 60°C or below -20°C) – this can deform the plastics with a leaking compass capsule as a result.
- Avoid dropping the compasses on hard surfaces and handle it with care.
- Don't store or place the compass close to strong magnetic fields such as knives, mobile phones, radio speakers, magnets etc. This can cause reversed polarity of the compass needle which will result in it pointing south instead of north.

#### WARRANTY

SILVA warrants that, for a period of five (5) years, your SILVA product will be substantially free of defects in materials and workmanship under normal use. Silvas liability under this warranty is limited to repairing or replacing the product. This limited warranty extends only to the original purchaser. If the product proves defective during the warranty period please contact the original place of purchase. Make sure to have your proof of purchase on hand when returning the product. Returns cannot be processed without the original proof of purchase. This warranty does not apply if the product has been altered, not been installed, operated, repaired, or maintained in accordance with instructions supplied by SILVA, or has been subjected to abnormal physical or electrical stress, misuse, negligence or accident. Neither does the warranty cover normal wear and tear. SILVA is not responsible for any consequences, direct or indirect, or damage resultant from use of this product. In no event will Silvas liability exceed the amount paid by you for the product. Some jurisdictions do not allow the exclusion or limitation of incidental or consequential damages, so the above limitation or exclusion may not apply to you. This Warranty is valid and may be processed only in the country of purchase.